

OPPORTUNITY FOR ARTISTS – PUBLIC ART COMMISSION

MATCHMAKERS WHARF, LONDON E9



Block B, Matchmakers Wharf, Homerton, E9 which, including the glass trapezoid, will provide 49 purpose-built artists' studios.

SUMMARY

Telford Homes and **Acme Studios** are offering the opportunity for an artist (or more than one artist if working collaboratively) to undertake a **permanent commission** at Matchmakers Wharf, Telford's new mixed-use development due to open in June 2012.

Matchmakers Wharf, currently under construction on the site of the Lesney Matchbox Toys Factory, is situated on the River Lee Navigation close to the Olympic Park and will consist of over 200 homes, offices, shops, commercial space and 49 purpose-designed artists' studios to be owned and managed by Acme.

The commission is for an external 'public artwork' located at a busy pedestrian intersection at the entrance to the development. The area designated for the work is at ground level and approximately triangular in shape and close to the artists' studios.

The partners are seeking an imaginative response to the architectural context and the 'function' of the designated area as a meeting and focal point for residents and visitors. The work may also reflect the history of the site and the locality more generally. It is envisaged that the work may include seating and planting, and could be interactive and involve the use of lighting.

The work will be expected to embrace the use of sustainable materials and construction techniques, be durable, and future running and maintenance costs should be low.

The value of the commission is a maximum of **£30,000** (to include fee, material, fabrication and installation costs). A separate budget will cover the costs of associated site preparation and the integration / landscaping of the commissioned work into the site.

Selection of the proposal will be via a **two-stage process**, with artists submitting indicative proposals by **27 May 2011** from which three proposals will be funded for further development. Artists selected for the second stage will receive a fee of £500 and be required to submit their detailed proposals by **5 August 2011**.

BACKGROUND

Matchmakers Wharf is new landmark mixed-use development by Telford Homes currently being built on the site of the former Lesney Matchbox Toys Factory in Homerton, E9. The development, in partnership with Acme Studios, is located to the north of the London 2012 Olympic Park, less than 200 metres from the International Broadcast Centre which will become a focus for creative industries after the Games. The development comprises 209 residential units which will become available for sale or as social housing, 49 artists' studios and commercial space for community, office and retail use. There will also be improved access to the River Lee Navigation with moorings for residential and commercial boats.

The scheme will create a permanent and high-quality resource for artists, contributing to London Borough of Hackney's commitment to encouraging creative industries and, through public engagement, bring real benefits to new residents and existing communities. Telford's recognise that including artists' studios within a new development creates a natural conduit to local communities and that studios hold a natural attraction; by having them integrated into the heart of the development other creative and commercial businesses will be attracted to the area.

Acme worked closely with Telford Homes, and the architects Stock Woolstencroft, throughout the planning process, who quickly understood the needs of artists and the benefits they would bring to the project.

Acme has a long history of working in the borough, having supported several hundred artists with combined housing and studio space throughout the 70s and 80s and has a permanent studio building in Orsman Road, N1. The studios at Matchmakers Wharf will be the last project in the current phase of Acme's current capital development programme, part-funded by a major grant from Arts Council England.

THE SITE



A visualisation of the designated area showing its scale and relationship with the site – the landscaping treatment is for illustrational purposes only

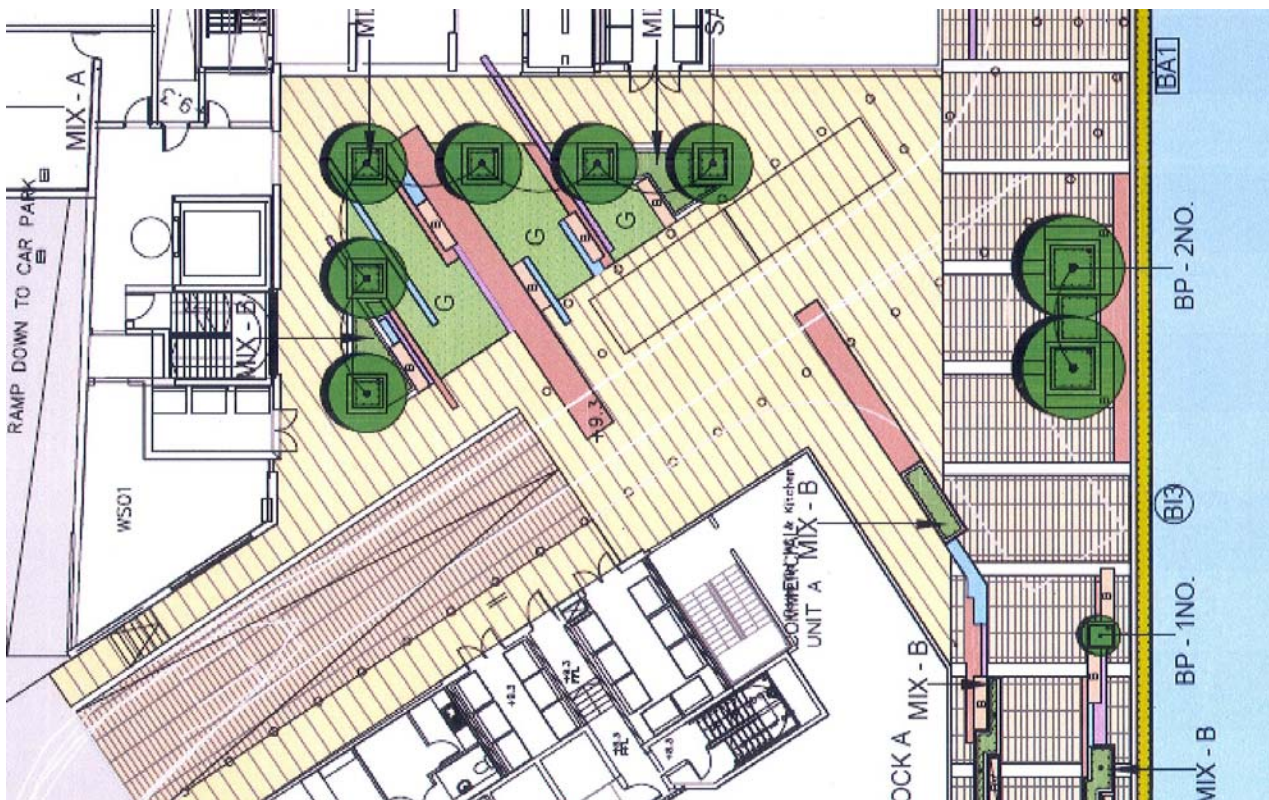

Plan showing designated area surrounded by paving with the main pedestrian and vehicular access to the site at bottom left and the towpath to the River Lee Navigation to the right

STAGE ONE

Artists wishing to apply for the commission will need to provide the following:

- Outline proposal (of no more than one page) together with an indicative budget.
- A curriculum vitae (including artist's statement)
- A maximum of 10 images (CD, DVD, or photographs) of recent work relevant to the proposed project (all should be labelled with: artist's name, date of work, materials used and project name / title)
- Catalogues or published articles, including reviews (which should be listed)

To arrive at a short-list the partners will consider the quality and appropriateness of the proposals, the history of the artists' practice and their capacity to deliver the commission. A maximum of three proposals will be short-listed and artists invited to submit to Stage 2.

Closing date: 27 May 2011, 12 noon

STAGE TWO

Three short-listed proposals will be awarded a fee of £500 for detailed development. A site visit will be arranged to view the designated area and further site and technical details (including access and health and safety) will be provided as required.

Written and visual material required for the Stage 2 submission (deadline **5 August 2011, 12 noon**) will be detailed at the time of invitation but in summary will include:

- A description of the concept and materials / technologies to be used, together with a visual representation of the proposed work
- Outline of all key technical issues relating to construction and installation
- Method statement and timetable for production, delivery and installation
- Ongoing maintenance requirements and indicative maintenance / running costs
- A detailed budget showing how the budget of £30,000 will be spent to include: fee, material, fabrication, delivery and installation costs, any sub-contracted costs, associated travel and other expenses.

Artists involved in the three short-listed proposals will be invited to interview, to be held in London on **15 August 2011** and the selected artist/s will be informed by **26 August 2011**

REALISATION

The selected artist/s will work with the partners to finalise all details of the realisation of the commission and enter into a contract for its delivery by **16 September 2011**. The work will need to meet health and safety and access guidelines and a risk assessment will be undertaken prior to the finalisation of the design. The installation of the work will need to be undertaken by suitably qualified individuals.

The work will be completed and launched in **May 2012**.

TIMETABLE

Stage one closing date	12 noon, Friday 27 May 2011
Three proposals short-listed	End of June 2011
Stage two closing date	12 noon, Friday 5 August 2011
Artists' interviews / presentations	Week of 16 August 2011
Selected artist/s informed	26 August 2011
Contract signed	16 September 2011
Commission completed and launched	May 2012

HOW TO APPLY

Please send your submission (as set out in Stage One above) to include: outline proposal and budget, curriculum vitae, images and published material **in hard copy format only** (submissions sent electronically will not be accepted) to:

Julia Lancaster
Residency and Projects Manager
Acme Studios
44 Copperfield Road
Bow
London E3 4RR

To arrive no later than: **12 noon, Friday 27 May 2011**

About Telford Homes

Telford Homes is an AIM listed new homes developer that delivers high quality mixed-tenure developments around East London. The Company has formed long-term partnerships with key London Boroughs to realise their commitment to regeneration and the formation of sustainable new communities. Telford Homes' brand values focus upon value-for-money and excellent delivery of both product and service.

Telford Homes' high standards and exceptional customer service have resulted in a number of awards, including three NHBC Seals of Excellence, London Evening Standard Special Commendation for Best New Small Development (2009), Innovation Award for Building Technology (2009), the prestigious Homebuilder of the Year award at the Mail on Sunday British Homes Awards 2009 and most recently two NHBC quality awards (June 2010) and a Commendation for Best Development Project (Matchmakers Wharf) at the British Homes Awards 2010. For more information please visit the Telford Homes' website at www.telfordhomes.plc.uk.

About Acme Studios

Founded by Jonathan Harvey and David Panton in 1972, Acme Studios is a London-based charity that provides artists with affordable studios and living space, residencies and awards. Its expanding Residency, Awards & Community Programme will support over 30 artists this year through the provision of rent-free studios, bursaries, mentoring and professional support. Many of the artists on residency programmes provide public benefit through their engagement with local communities.

Acme manages over 425 studios in 12 buildings across London and continues to pioneer new ways of achieving affordable studios working in partnership with commercial house builders and social housing providers. For more information please visit the Acme Studios' website at www.acme.org.uk



Supported by
**ARTS COUNCIL
ENGLAND**